

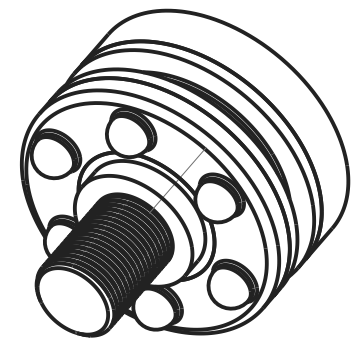

REVISIONS				
DRAWN	REV	DESCRIPTION	DATE	APPROVED
TC	-	INITIAL RELEASE	7-9-09	JS
TC	A	Added tool locating feature to threaded insert. Increased the insert head by .35mm and increased the shoulder dia from 5.0 to 5.2mm. Decreased the rib count from 8 to 6. Decreased the U-Ring thickness from 2.5 to 2.1mm.	8-6-09	JS
TC	02	SPLIT PRINT INTO SEPERATE DRAWINGS	3-22-11	MS
TC	03	UPDATED NAMING CONVENTION, ADDED GATE AND FLASH TOL	6-14-12	MS

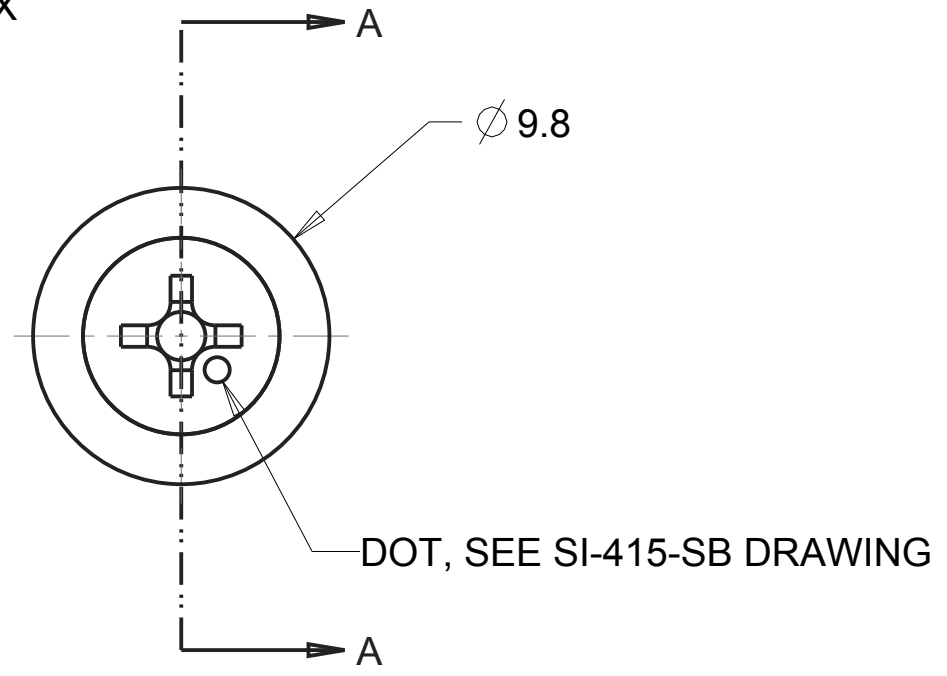
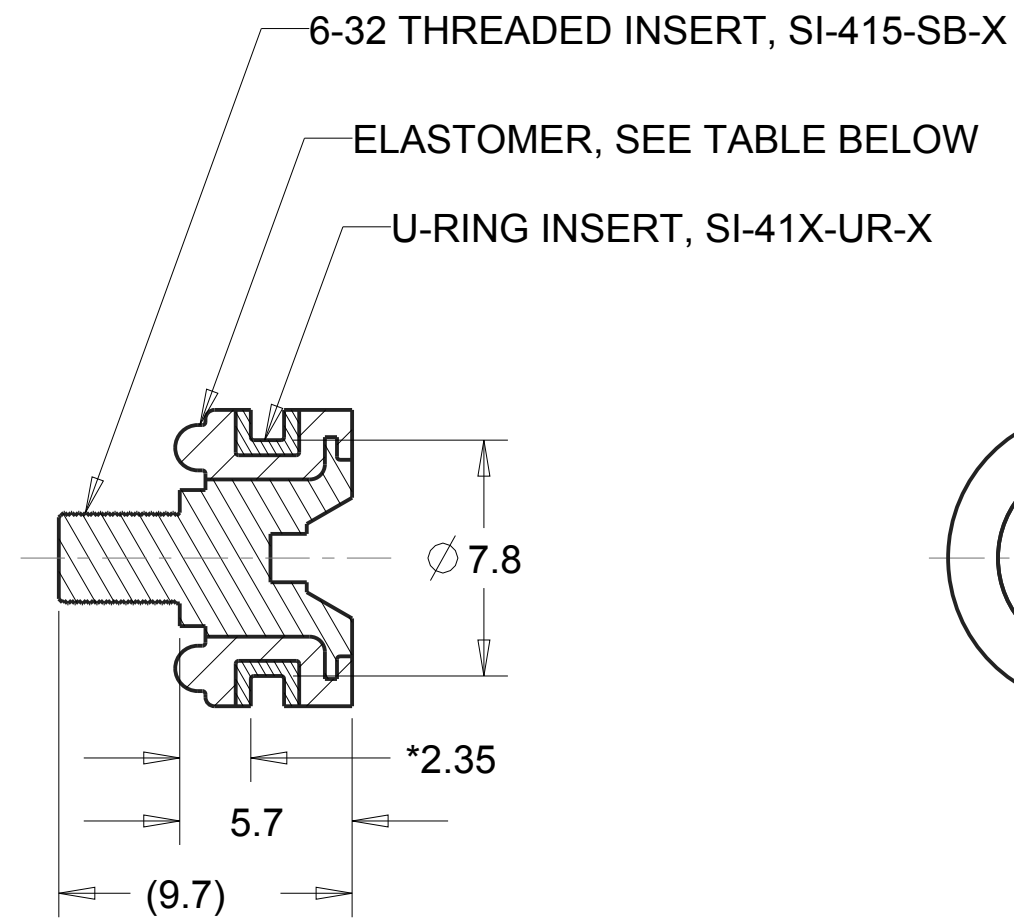

SECTION A-A

- 5. USE THE TOLERANCE TABLE ON THE LEFT FOR ELASTOMERS.
- 4. FOR THREADED INSERT: CRITICAL DIM TOL:  $\pm .08\text{MM}$ . ALL OTHER DIM TOL:  $\pm .10\text{MM}$ .
- 3. FOR THREADED INSERT: ASTM B-117 (72 HOURS).
- 2. CRITICAL DIMENSIONS SHALL HAVE Cpk VALUE  $\geq 1.33$  WITH ONGOING SPC DATA REQUIRED.
- 1. CRITICAL DIMENSIONS ARE MARKED WITH "\*".

NOTES:

SI-415-C8012	C-8012
SI-415-C8002	C-8002
SI-415-C8001	C-8001
SI-415-C1002	C-1002
PART #	MATERIAL

RANGE	TOL
0<DIM<=2	$\pm 0.15$
2<DIM<=25	$\pm 0.25$
25<DIM<=50	$\pm 0.4$
50<DIM	$\pm 0.6$

UNLESS OTHERWISE SPECIFIED UNITS ARE: MM [IN] TOLERANCE FOR ANGLES: $\pm 1.0^\circ$		MATERIAL: <b>SEE TABLE</b>		AEARO TECHNOLOGIES LLC * a 3M company	
ALLOWABLE FLASH: $\pm .12\text{MM}$		QUALITY CONTROL: MUST COMPLY WITH E-A-R SPECIALTY COMPOSITES SUPPLIER QUALITY MANUAL REQUIREMENTS		TITLE <b>SI-415 GROMMET</b>	
GATE: $\pm .15\text{MM}$		NOTES: ANY FEATURE NOT DIMENSIONED IN PRINT MUST BE VISIBLY PRESENT, UTILIZE 3D CAD FOR CREATION		SIZE <b>B</b>	DRAWING NO. <b>SI-415-X</b>
				PAGE NO. <b>1 OF 1</b>	